

**Multi-Look® LED Lampe PLUS
Sockel BA15d
MWGD15xx9**

Multi-Look® LED Lampe mit 4 Chip-LEDs.
Durch die Versiegelung der Chip-LEDs wird
sowohl eine Vergrößerung des Abstrahl-
winkels als auch ein hoher mechanischer
Schutz erreicht.

**Multi-Look® LED lamp PLUS
socket BA15d
MWGD15xx9**

*Multi-Look® LED lamp with 4 Chip-LEDs.
By sealing the Chip-LEDs, both an enlarge-
ment of the beam angle and a high
mechanical protection will be achieved.*

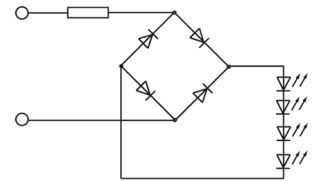
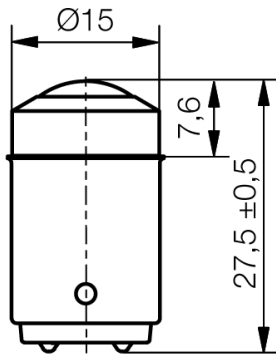

Spezifikation

Maße: Ø15 mm x 27,5 mm

Sockel: BA15d

Betriebsspannung: 24/28V AC/DC

130V AC/DC

230V AC/DC

Specification

Dimensions: Ø15 mm x 27,5 mm

Socket: BA15d

Operating voltage: 24/28V AC/DC

130V AC/DC

230V AC/DC

Materialien

| Teil | Material |
|---------|----------------------------------|
| Gehäuse | Polycarbonat (PC) in Leuchtfarbe |

Betriebstemperatur -30°C/+75°C

Lagertemperatur -40°C/+100°C

Material

| Part | Material |
|---------|-----------------------------|
| Housing | Polycarbonat (PC) pigmented |

Operation Temperature -30°C/+75°C













Storage Temperature -40°C/+100°C

Optionen

- Sockel BA15s
- Sockel E14
- Andere Spannungen lieferbar

Options

- Socket BA15s
- Socket E14
- Other voltages available

| Artikel/ Part | | Artikel-Text | | | | | Part-Text | | | | |
|---------------------|--|--|-----------------------------|-----------------------------|----------------------------------|--|---|-------------------|-----------------------------|-----------------------------|--|
| Spannung Voltage | Farbe Color | Lichtstärke Luminous Intensity | Vollwinkel Viewing Angle | Lichtstrom Luminous Flux | Leuchtdichte luminous density | Beleuchtungsstärke Illumination Level | Strom Current | Leistung Power | Lebensdauer Life-Time(L) | Anzahl LED Number of LED | |
| MWGD15049 | | Multi-Look® ROT 24/28V AC/DC BA15d | | | | | Multi-Look® RED 24/28V AC/DC BA15d | | | | |
| 24 V |  rot red | 900 mcd/ @ 20,000 mA | 150° | lm | | | 14,5mA | 350 mW | 60000 h | 4 | |
| MWGD15079 | | Multi-Look® ROT 130V AC/DC BA15d | | | | | Multi-Look® RED 130V AC/DC BA15d | | | | |
| 130 V |  rot red | 900 mcd/ @ 20,000 mA | 150° | lm | | | 5,5mA | 720 mW | 60000 h | 4 | |
| MWGD15089 | | Multi-Look® ROT 230V AC/DC BA15d | | | | | Multi-Look® RED 230V AC/DC BA15d | | | | |
| 230 V |  rot red | 900 mcd/ @ 20,000 mA | 150° | lm | | | 3,1mA | 700 mW | 60000 h | 4 | |
| MWGD15149 | | Multi-Look® GELB 24/28V AC/DC BA15d | | | | | Multi-Look® YELLOW 24/28V AC/DC BA15d | | | | |
| 24 V |  gelb yellow | 720 mcd/ @ 20,000 mA | 150° | lm | | | 14,5mA | 350 mW | 60000 h | 4 | |
| MWGD15179 | | Multi-Look® GELB 130V AC/DC BA15d | | | | | Multi-Look® YELLOW 130V AC/DC BA15d | | | | |
| 130 V |  gelb yellow | 720 mcd/ @ 20,000 mA | 150° | lm | | | 5,5mA | 720 mW | 60000 h | 4 | |
| MWGD15189 | | Multi-Look® GELB 230V AC/DC BA15d | | | | | Multi-Look® YELLOW 230V AC/DC BA15d | | | | |
| 230 V |  gelb yellow | 720 mcd/ @ 20,000 mA | 150° | lm | | | 3,1mA | 700 mW | 60000 h | 4 | |
| MWGD15449 | | Multi-Look® BLAU 24/28V AC/DC BA15d | | | | | Multi-Look® BLUE 24/28V AC/DC BA15d | | | | |
| 24 V |  blau blue | 1.000 mcd/ @ 20,000 mA | 150° | lm | | | 15,4mA | 380 mW | 60000 h | 4 | |
| MWGD15489 | | Multi-Look® BLAU 230V AC/DC BA15d | | | | | Multi-Look® BLUE 230V AC/DC BA15d | | | | |
| 230 V |  blau blue | 1.000 mcd/ @ 20,000 mA | 150° | lm | | | 3 mA | 700 mW | 60000 h | 4 | |
| MWGD15549 | | Multi-Look® WARMWEISS 3000K 24/28V AC/DC BA15d | | | | | Multi-Look® WARM WHITE 3000K 24/28V AC/DC | | | | |
| 24 V |  warmweiß warm white | 5.000 mcd/ @ 20,000 mA | 150° | lm | | | 15,4mA | 380 mW | 60000 h | 4 | |
| MWGD15589 | | Multi-Look® WARMWEISS 3000K 230V AC/DC BA15d | | | | | Multi-Look® WARM WHITE 3000K 230V AC/DC BA15d | | | | |
| 230 V |  warmweiß warm white | 5.000 mcd/ @ 20,000 mA | 150° | lm | | | 3 mA | 700 mW | 60000 h | 4 | |
| MWGD15649 | | Multi-Look® WEISS 24/28V AC/DC BA15d | | | | | Multi-Look® WHITE 24/28V AC/DC BA15d | | | | |
| 24 V |  weiß white | 5.000 mcd/ @ 20,000 mA | 150° | lm | | | 15,4mA | 380 mW | 60000 h | 4 | |
| MWGD15679 | | Multi-Look® WEISS 130V AC/DC BA15d | | | | | Multi-Look® WHITE 130V AC/DC BA15d | | | | |
| 130 V |  weiß white | 5.000 mcd/ @ 20,000 mA | 150° | lm | | | 5,3mA | 700 mW | 60000 h | 4 | |
| MWGD15689 | | Multi-Look® WEISS 230V AC/DC BA15d | | | | | Multi-Look® WHITE 230V AC/DC BA15d | | | | |
| 230 V |  weiß white | 5.000 mcd/ @ 20,000 mA | 150° | lm | | | 3 mA | 700 mW | 60000 h | 4 | |
| MWGD15749 | | Multi-Look® UGRÜN 24/28V AC/DC BA15d | | | | | Multi-Look® UGREEN 24/28V AC/DC BA15d | | | | |
| 24 V |  ugrün ugreen | 3.500 mcd/ @ 20,000 mA | 150° | lm | | | 15,4mA | 380 mW | 60000 h | 4 | |
| MWGD15779 | | Multi-Look® UGRÜN 130V AC/DC BA15d | | | | | Multi-Look® UGREEN 130V AC/DC BA15d | | | | |
| 130 V |  ugrün ugreen | 3.500 mcd/ @ 20,000 mA | 150° | lm | | | 5,3mA | 700 mW | 60000 h | 4 | |
| MWGD15789 | | Multi-Look® UGRÜN 230V AC/DC BA15d | | | | | Multi-Look® UGREEN 230V AC/DC BA15d | | | | |
| 230 V |  ugrün ugreen | 3.500 mcd/ @ 20,000 mA | 150° | lm | | | 3 mA | 700 mW | 60000 h | 4 | |

(1) Lebensdauer bei 25° C Umgebungstemperatur

LT

Lebensdauer: Die Lebensdauer einer LED ist definiert als Abnahme der Helligkeit auf 50% des Ausgangswertes

The life time of an LED is defined as decrease of brightness by 50% of the initial value

Technische Änderungen vorbehalten. Datenblatt unterliegt nicht dem Änderungsdienst.
Die angegebenen technischen Daten sind typische Durchschnittswerte.

Helligkeitswerte nach CIE127 falls nicht anders angegeben.

Wir empfehlen das Dokument mit der Einstellung "Seitengröße anpassen" zu Drucken

Wir achten bei Entwicklung und Herstellung unserer Produkte auf einen möglichst geringen Einsatz von Ressourcen und auf niedrigen Energiebedarf im Betrieb.

Bitte prüfen Sie, ob es unbedingt erforderlich ist, das gesamte Dokument zu Drucken. So schonen Sie zusätzlich Ressourcen und unsere Umwelt.

Signal-Construct elektro-optische
Anzeigen und Systeme GmbH

Brückenäckerweg 4
DE 75223 Niefern

Tel. +49 7233 9531-0
Fax +49 7233 9531-29

email info@signal-construct.de
web <http://www.signal-construct.de>

Specifications are subject to change without notice.

The technical data are typical figures.

Photometry according to CIE127 unless otherwise indicated.

We recommend to print the document with option "Fit to Page"

We care for environment when producing and manufacturing our products. Also we care for a low power consumption and a low consumption of resources.

Please consider environmental responsibility before printing this document